

STATE-OF-ART HYDRAULIC
FIXTURES

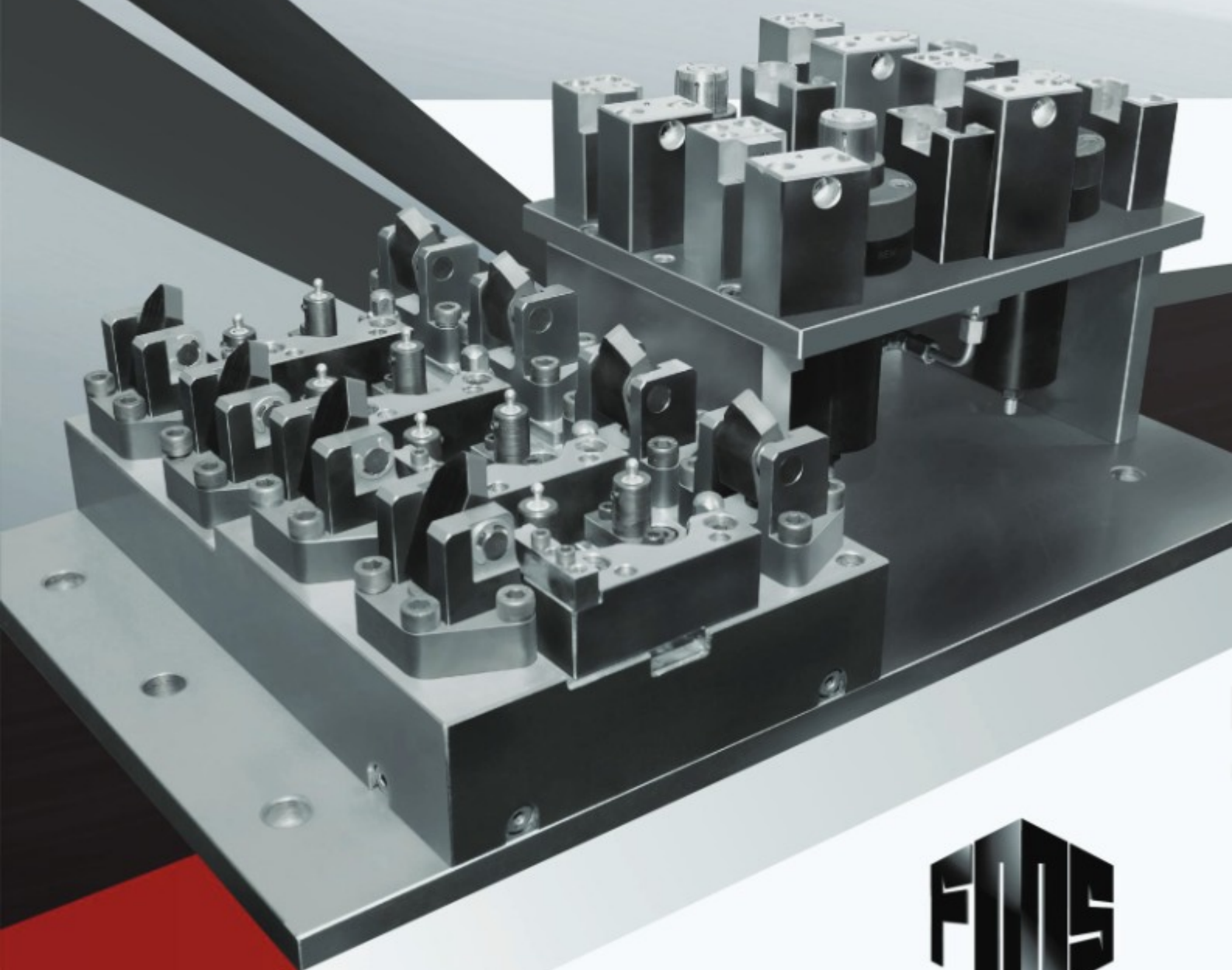

QUALITY SINCE 2007

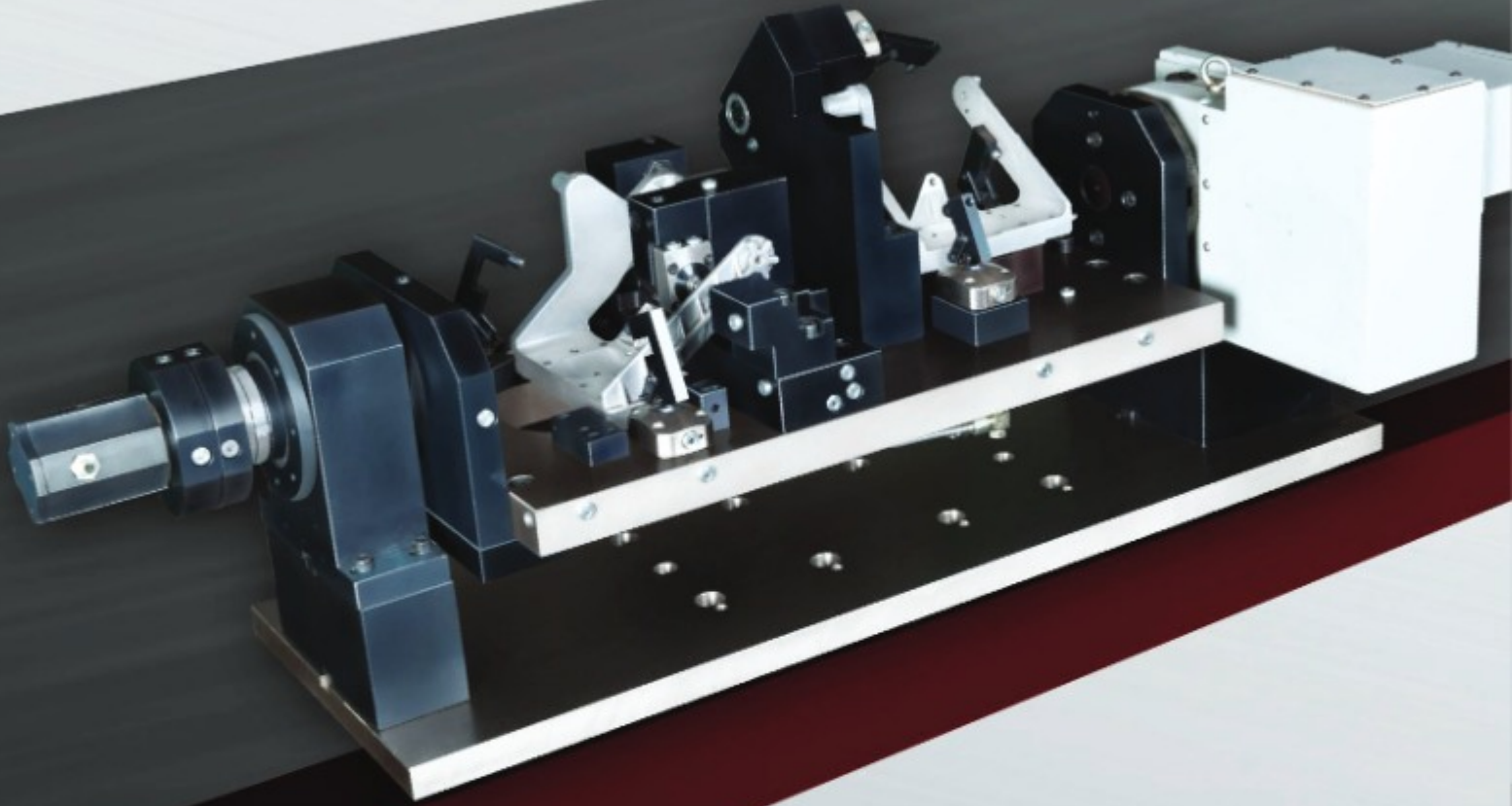

THE PROFILE

FMS Industries Is a leading hydraulic Fixture Manufacturing company, established in the Year 2007 by K. Vijay Anand a young and energetic engineer who has a vision to serve the manufacturing industries.

FMS not only manufactures but also provides solutions for the fixture manufacturing system suppliers. The focus is on designing and manufacturing with the latest and innovative technologies. The modern manufacturing facilities and skilled technical workforce enable the production of highly in demand hydraulic fixtures, pneumatic fixtures and SPM's.

The quality products find wide application in industries like aerospace, automotive, commercial vehicle, electronics, telecommunication, hydraulics, mechatronics, robotics and textile industries.



QUALITY STANDARDS

FMS Industries is an ISO certified company with ISO 9001:2008 in Design & Manufacturing from TUV NORD. The company also adheres to stringent quality check through a quality team consisting of technical experts at every step to ensure that only 100% quality products leave its premises.

THE MISSION

To deliver quality, reliable and user friendly products and service to customers on time through continued innovation

DESIGNING EDGE

The design and development department uses high end technologies including fully licensed software to design innovative products that provides resourceful problem solving capabilities.

PRODUCT FEATURES

FMS products carry salient features that are comparable with the best the world over. The features includes

- Poka-Yoke system
- Part sensing mechanism
- Manifold type base plates up to 800mm
- Manufacturing of customized collets
- Electroless plating for easy chip flow
- Manufacturing of special cylinders

IN-HOUSE MACHINING

The in-house machining capabilities using cutting edge machinery ensures products of high precision and perfection. The remarkable machining capabilities are,

- BFW Agni VMC machine
- BFW VF1 heavy duty milling machine
- FIRST M1TR with Rotary Indexing with bed size 1000x250 mm (imported)
- Hi-Tech M1TR with Rotary Indexing with bed size 1270x250 mm (imported)
- Surface Grinding Machine
- High Power Precision Lathe 6.5' Heavy Duty
- High Power Lathe 4.5' Heavy Duty
- Sona All Geared Head Stock 4.5 Lathe
- Portable Drilling Machine
- Pedestal Grinding Machine
- Yuken Hydraulic Power Pack System
- Suguna Air Compressor System



PRODUCT RANGE

FMS offers product solutions for a range of hydraulic, pneumatic fixtures and SMP's requirements.

5 Operations in 1 fixture 10 stations

HYDRAULIC
FIXTURES
FOR VMC

- All hydraulic lines are linked by internal manifold type base plates.
- Easy chip flow.
- Rust free by Electroless plating.
- Small parts are blackened.
- Poka-Yoke system to avoid mistakes.
- Imported hydraulic cylinders for better life.
- Imported hydraulic connection and distributor to prevent leakage.

ADVANTAGES

- All operation in single fixture.
- Easy loading & unloading.
- Easy handling.
- Less space required.
- Prevents from rust.

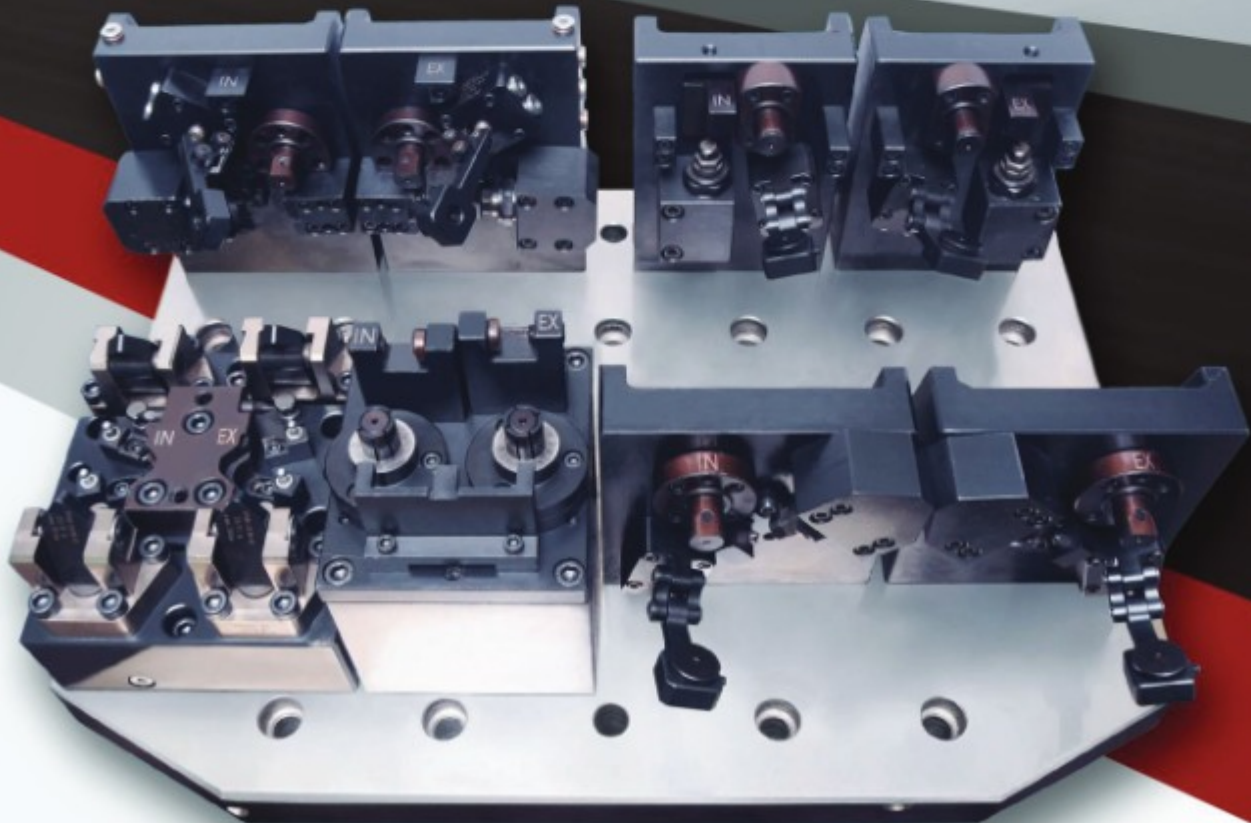

Eight stations in one fixture

- Internal manifold.
- Rust free by Electroless plating.
- Small parts are blackened.
- Imported hydraulic cylinders for better life.
- Imported hydraulic connection and distributor to prevent leakage.
- Easy chip flow.

ADVANTAGES

- Easy handling.
- Less space required.
- Less time for loading & unloading the component.
- Smart Design.
- Prevents from rust.

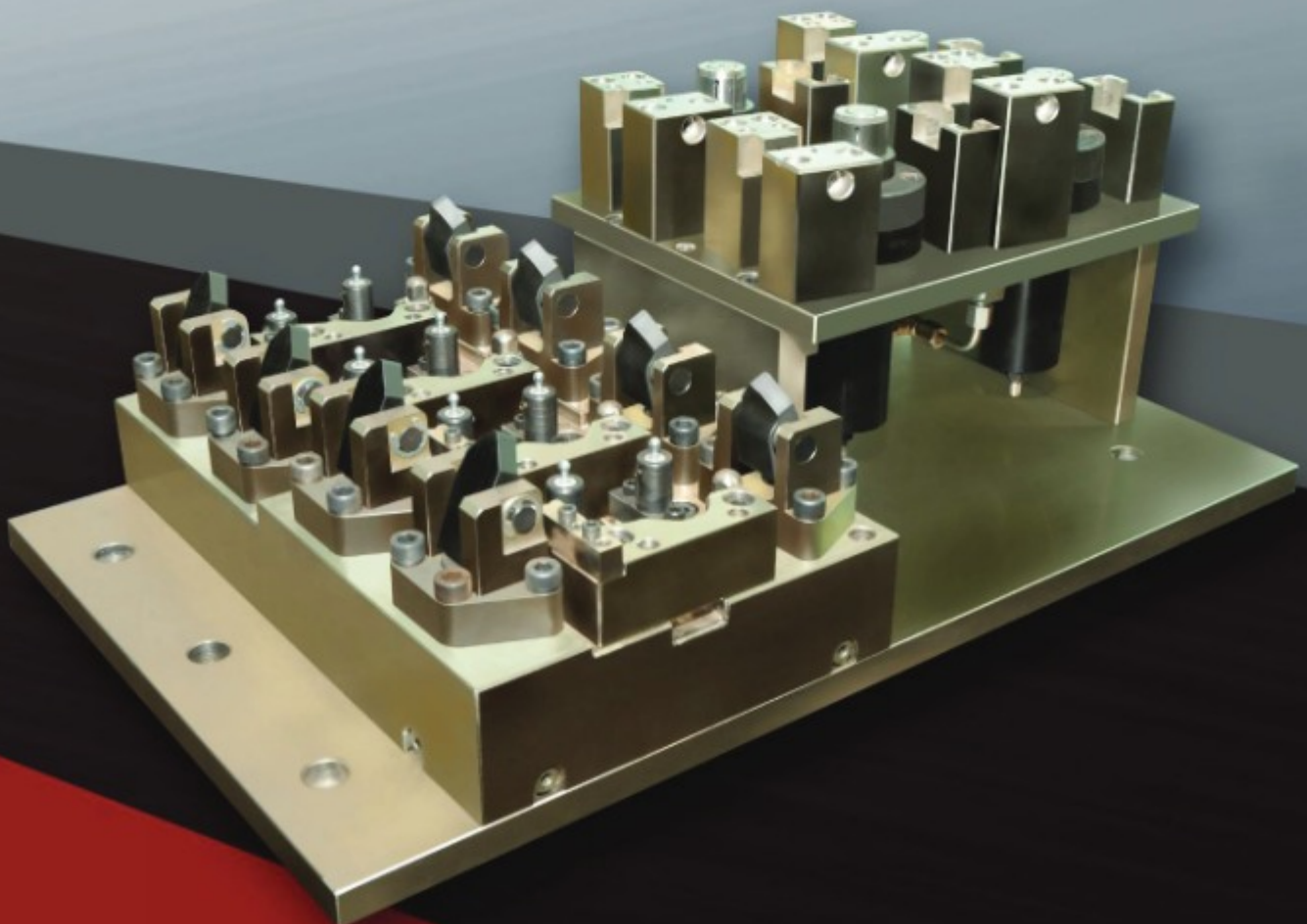



Four stations in one fixture

- Internal manifold type base plates.
- Compact and smart design.
- Rust free by Electroless plating.
- Small parts are blackened.
- Imported hydraulic cylinders for better life.
- Imported hydraulic connection and distributor to prevent leakage.
- Easy chip flow.

ADVANTAGES

- Easy handling.
- Long life.
- Less space required.
- Easy loading and unloading.
- Prevents from rust.

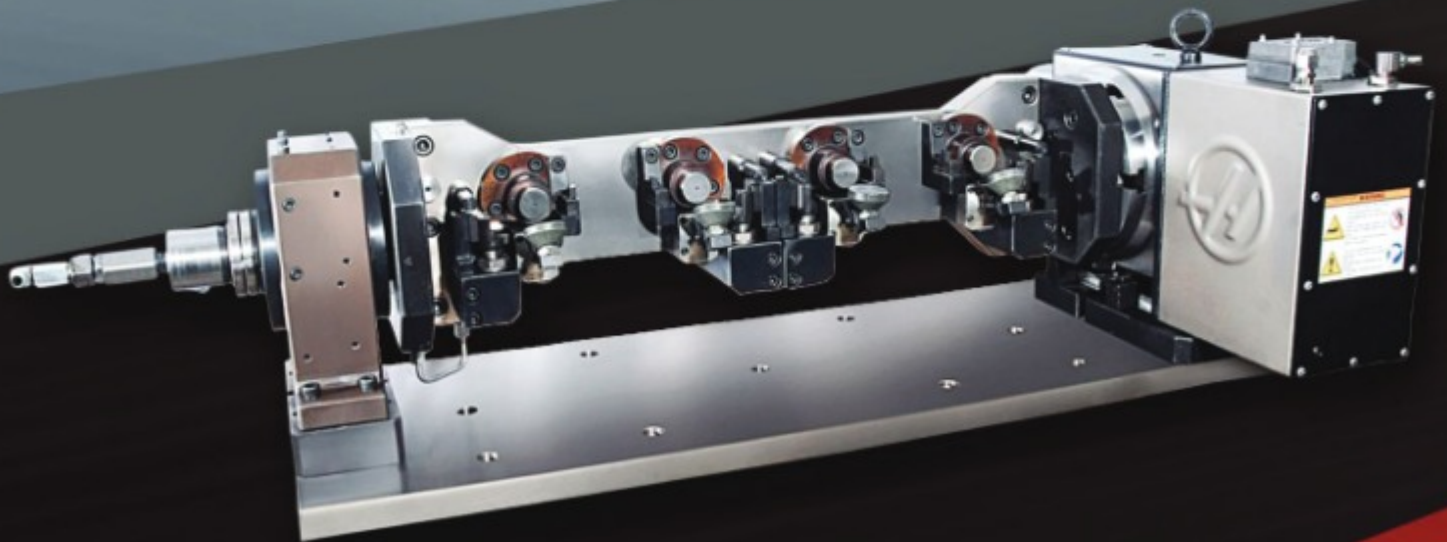

FIXTURE FOR 4th AXIS – VMC

- Internal manifold.
- Rust free by Electroless plating.
- Small parts are blackened.
- Imported hydraulic cylinders for better life.
- Imported hydraulic connection and distributor to prevent leakage.
- Easy chip flow.

ADVANTAGES

- Easy handling.
- Easy loading & unloading.
- Less space required.
- Prevents from rust.

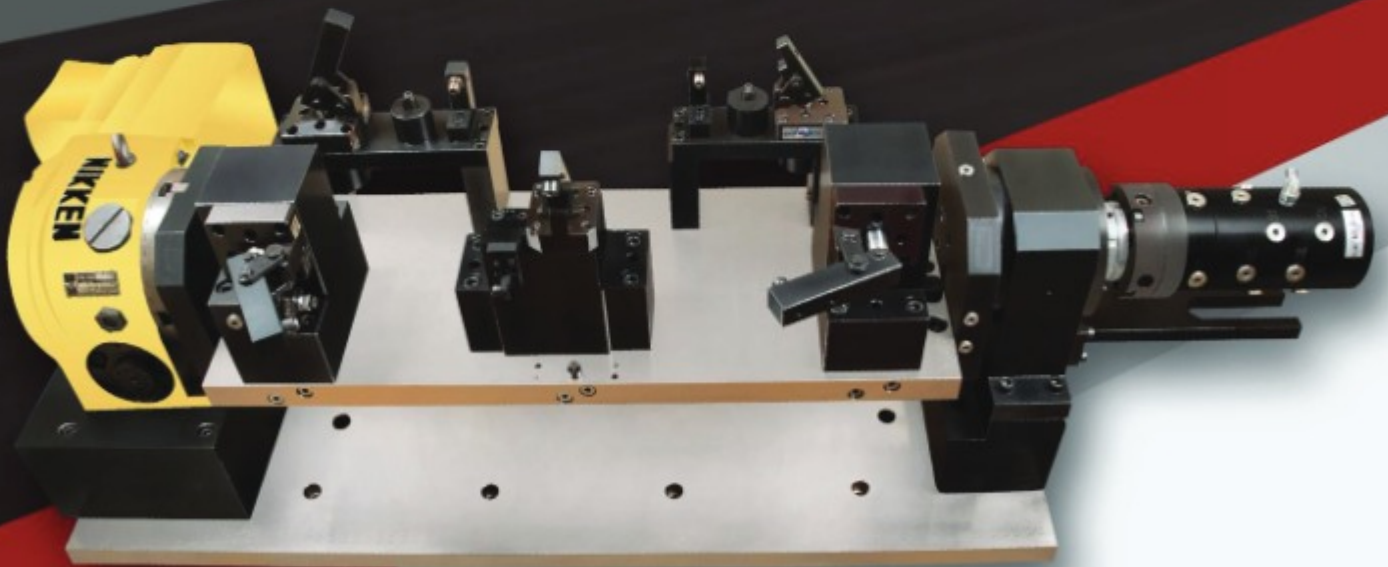

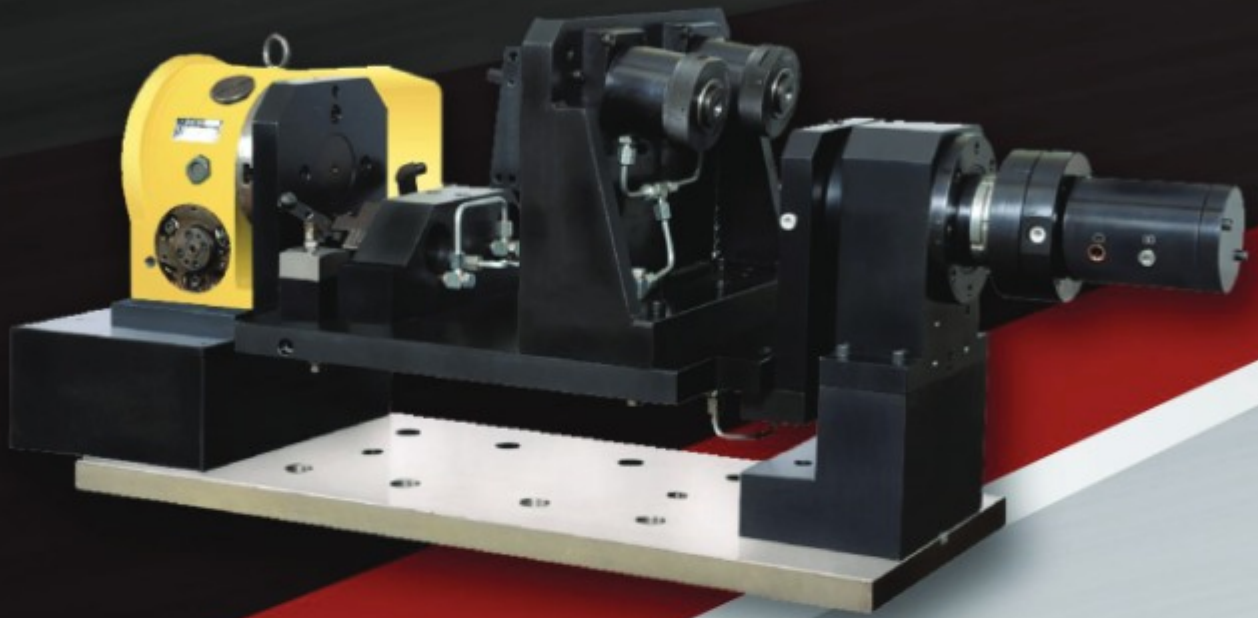

FIXTURE FOR 4th AXIS – VMC

- Internal manifold.
- Part sensing mechanism is to identify the component whether it is present or not.
- Rust free by Electroless plating.
- Small parts are blackened.
- Imported hydraulic cylinders for better life.
- Imported hydraulic connection and distributor to prevent leakage.
- Easy chip flow.

ADVANTAGES

- Easy handling.
- Easy loading & unloading.
- Less space required.
- Prevents from rust.

Two & Three stations in one fixture

- All hydraulic lines are linked by internal manifold type base plates.
- Easy burr flow and Better life.
- Imported hydraulic connection.
- Electroless plating for base plates to prevent from rust and other small parts are blackened.
- Imported hydraulic cylinders and distributor to prevent leakage.

ADVANTAGES

- Easy handling.
- Long life.
- Less space required.
- Less time for loading & unloading the component.
- Smart design.
- Prevents from rust.



▲ Two Stations in One Fixture



▲ Three Stations in One Fixture



Six stations in one fixture

- All hydraulic lines are linked by internal manifold type base plates.
- Rust free by Electroless plating.
- Imported hydraulic connection and distributor to prevent leakage.
- Small parts are blackened.
- Imported hydraulic cylinders for better life.
- Easy burr flow.

ADVANTAGES

- Easy handling.
- Long life.
- Less space required.
- Prevents from rust.
- Easy Chip Flow.





HYDRAULIC
FIXTURES
FOR HMC

Two & Three stations in one fixture

- External manifold.
- Easy chip flow.
- Rust free by Electroless plating.
- Imported hydraulic cylinders for better life.
- Imported hydraulic connection and distributor to prevent leakage.

ADVANTAGES

- Easy handling.
- Long life.
- Less space required.
- Prevents from rust.



4th Axis Rotary Fixture

- All hydraulic lines are linked by internal manifold type base plates.
- Easy chip flow.
- Rust free by Electroless plating.
- Small parts are blackened.
- Poka-Yoke system to avoid mistakes.
- Imported hydraulic cylinders for better life.
- Imported hydraulic connection and distributor to prevent leakage.

ADVANTAGES

- All operation in single fixture.
- Easy loading & unloading.
- Easy handling.
- Less space required.
- Prevents from rust.

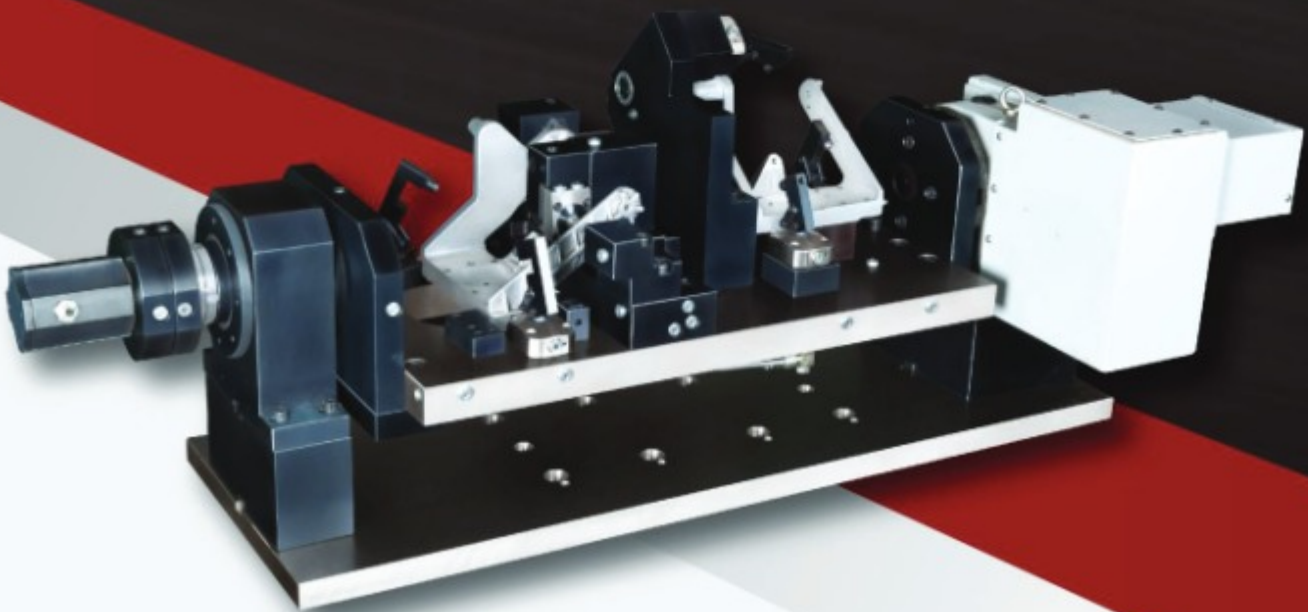

4th Axis Rotary Fixture

- Internal manifold.
- Part sensing mechanism is to identify the component whether it is present or not.
- Rust free by Electroless plating.
- Small parts are blackened.
- Imported hydraulic cylinders for better life.
- Imported hydraulic connection and distributor to prevent leakage.
- Easy chip flow.

ADVANTAGES

- Easy handling.
- Long life.
- Less space required.
- Less time for loading & unloading the component.
- Smart Design.
- Prevents from rust.

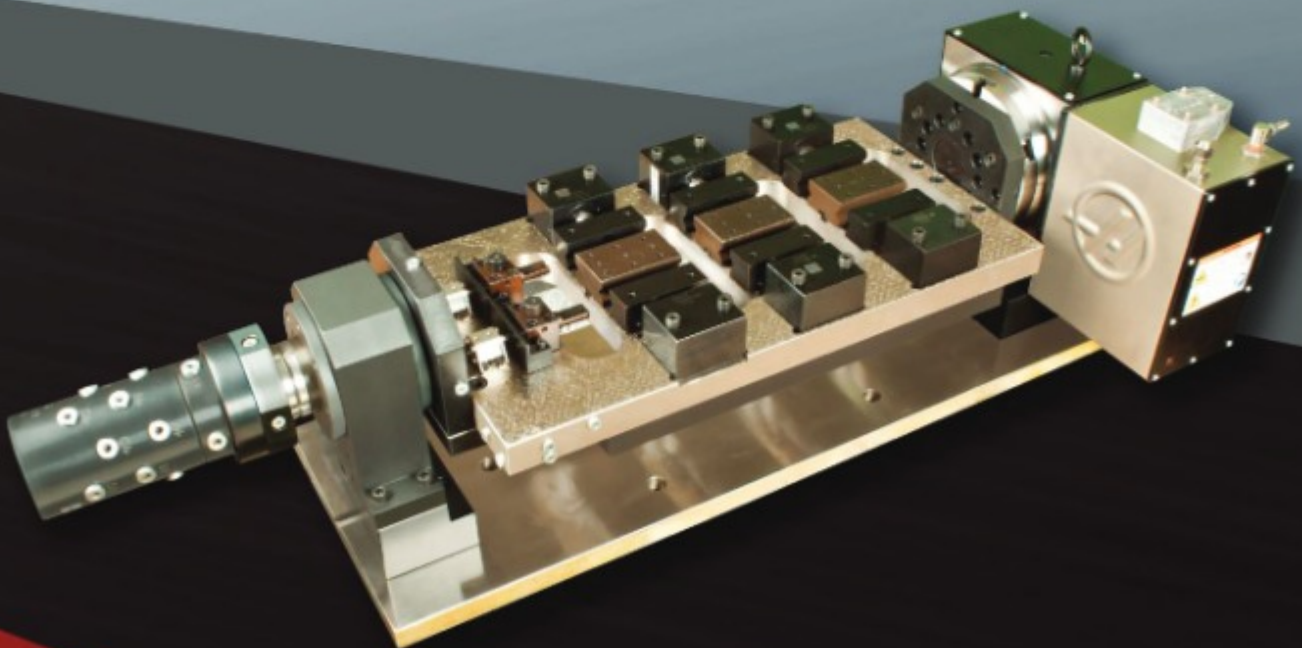



PORTFOLIO OF LEADING CLIENTS

 4i Technologies	 Alucast Belgium	 Ashley India Ltd	 Axles India Ltd
 Brakes India Ltd	 CRP Industries Ltd	 Dymos Lear	 Dolphin Machining Solutions
 Dynamics Technology Ltd	 Elcomachs India	 Gnutti Carlo India Pvt Ltd	 Iljin India Ltd
 KKR Industries	 L&P Somappa Comfort Systems	 Madras Engineering Industries	 Magal Tech India Ltd
 Mid Range Products Ltd	 MM Forgings Ltd	 Myunghwa India Ltd	 PHA India (P) Ltd
 Real Talent Engineers	 Saehan Pressings Pvt Ltd	 Simpson And Co Ltd	 Sny Autotech Pvt Ltd
 Sonasomic India Pvt Ltd	 Sri Balaji Castings Pvt Ltd	 Sundaram Clayton Ltd	 Super Auto Forge Ltd
 TAFE	 Triad India Ltd	 TVS Wabco Ltd	 Ucal Machine Tools Ltd



CERTIFICATE

This is to Certify that the Management System of
FMS INDUSTRIES



G6F, SIDCO INDUSTRIAL ESTATE, KAKKALUR,
THIRUVALLUR - 602003, INDIA.

has been assessed and found to be in compliance with the
requirements of the standard

ISO 9001: 2015

Quality Management System

This certificate is valid for the following products or service range

**DESIGN, MANUFACTURING OF MANUAL, PNEUMATIC & HYDRAULIC
FIXTURES FOR MACHINING METAL COMPONENTS**

The validity of certificate is subject to regular surveillance audit on or before above
mentioned dates and it's only valid after successful surveillance with continuation letter
issued by UCSPL

Initial Date of Certification : 20/01/2023

Current Date of Certification : 20/01/2023

Date of Expiry :
19/01/2026

1st Surveillance Audit
19 January 2024

Certification Number :
UCS8022-23B00148

2nd Surveillance Audit
19 January 2025



Signature
Authorised Signatory



KAB

UNIVERSAL CERTIFICATION SERVICES PVT. LTD.

E-mail : universalcertificationservices@gmail.com

Web : www.universalcertification.co.in

We are members of



Factory Address:

Plot No: G6F, SIDCO
Industrial Estate, Kakkalur
Thiruvallur - 602 003

Mobile : +91 99406 57815
044-2766 1976

Email : fmsindustries@gmail.com
URL : www.fmsindustries.in